

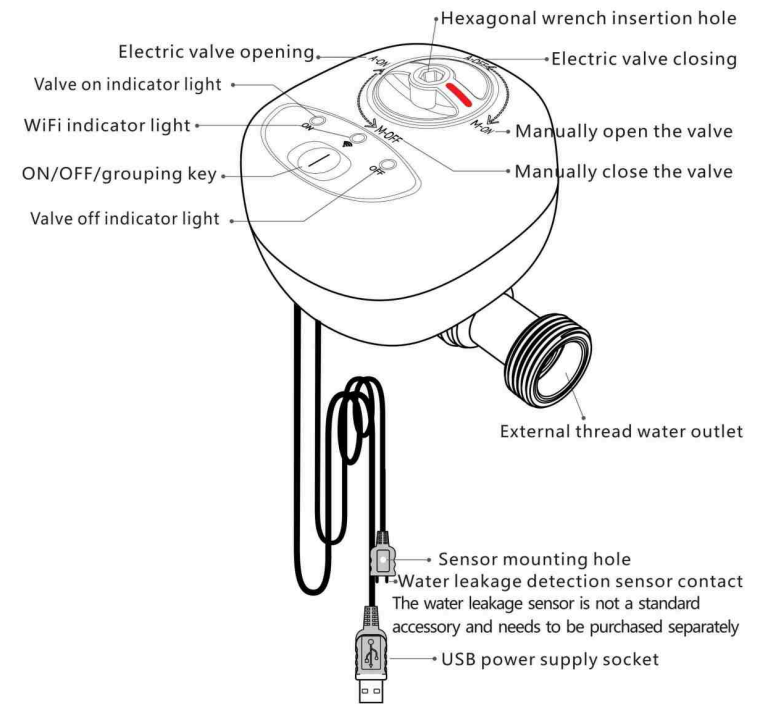

Installation and User Manual for CZC20S...  
Series Smart Valve with Manual Auxiliary  
Leakage Protection

Version No.: Version 2025031901-tuya01

1、Quickly get to know the product



Operation instructions for valve on and off buttons

Short press the button: Key < 5 (S)	Valve ON/OFF operation
Long press the button: Key ≥ 7 (s)	Restore factory settings

LED describe (APP-enabled indicator light can be turned off)

Green light always on	All valves have been opened
Green light flashing	Failure during valve opening or in the process of valve opening
red light always on	All valves have been close
red light flashing	Failure during valve opening or in the process of valve close
blue light always on	Successfully connected to the network
blue light flashing	Not connected to the network or the device is offline

## 2、product overview

The CZC20S... series of manually assisted leak protection smart valves are widely used in IoT and smart home systems. They generally operate on DC5V external switching power supply, but can be specially customized for AC/DC6-24V power supply and 3.3-5.5V DC motor drive. Equipped with a built-in multi-function button, the valve can be opened and closed with a light touch. Holding the "button" for more than 7 seconds allows for network configuration or clearing the original network, restoring factory settings.

## 3、Product technical specifications

Input voltage: DC5V or AC/DC6-24V

Input current: 0.3-0.5A when the motor is working, 0.05-0.1A when it is in standby mode

Communication module: High-performance dual communication module for WiFi and BLE

Operating environment: -20°C to 50°C

humidity ≤80%Material of casing: Flame-retardant PC or ABS

## 4、Product model description

Preparation Instructions: The preparation is divided into six sections. The first three sections represent the actuator parameters, while the last three sections represent the valve body parameters. Detailed product models and factory SNs are affixed to both the packaging box and the lower part of the actuator when the product is shipped.

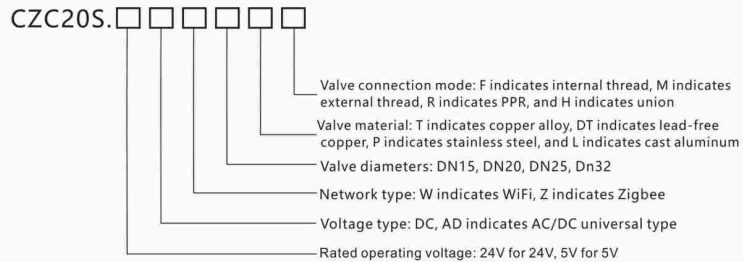

## 5、Product external dimensions description

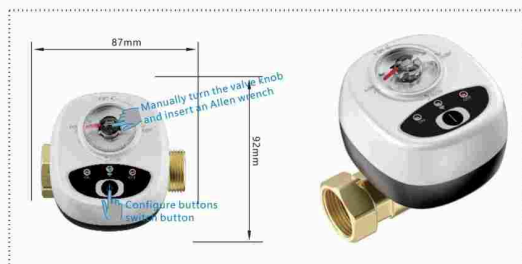

## 6、Connect with mobile APP

6.1. Scan the QR code with your phone, or search for "tuya Smart (Smart Life)" in the app market.



tuya Smart



Intelligent Life

**i** If the "tuya Smart (Smart Life)" app has already been installed on your phone, please ensure it is the latest version.

6.2. Open the tuya app. When using it for the first time, please register/log in to a Doodle account according to the app's instructions

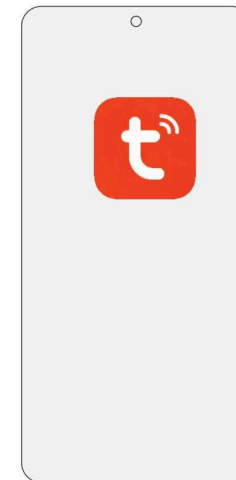

**i** The WLAN, GPS, and Bluetooth functions of the mobile phone need to be kept turned on

## 7、Add the device to the APP

7.1、 Log in to the Doodle APP, power on the device for the first time, turn on GPS and Bluetooth, and an automatic device discovery pop-up will appear for addition.

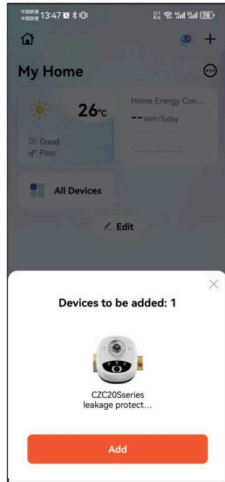

**i** The mobile phone WLAN must be connected to 2.4G WiFi, and currently does not support 5G or mixed 2.4G/5G WiFi.

7.2、 Log in to the tuya APP. When the device is powered on for the first time, click the "+" button in the top right corner and select "Add Device". Then, hold your phone near the device, and the APP will automatically scan for the device.



## 8、APP operation interface

After successful connection, the status will display as either "ON" (with the power button illuminated in blue) or "OFF" (with the power button dimmed).

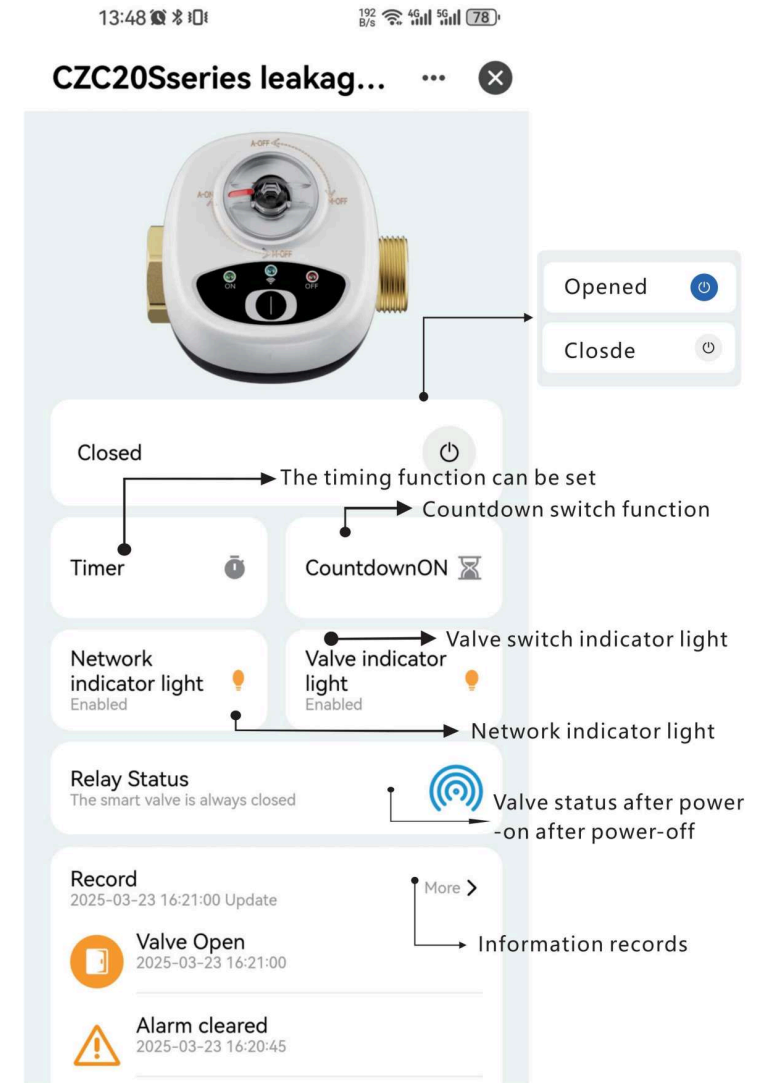

## 9、Operational flowchart for valve opening and closing functions

